



JTgk-500H

High Speed Engraving and Milling CNC Machine

Product descriptions and features

Features

- New generation CNC controller
- High efficiency and high precision machining
- Excellent metal machining performance
- Good vibration suppression performance
- Auto-wash function, easier machine cleaning
- Favorable man-machine interface, easy operation

For Material

Aluminum alloy, copper

Applied Range

Mold, electrode, parts, etc



KEJIE website



KEJIE wechat

Parameters

Item	Parameter
Machining area X/Y/Z	500/400/200[mm]
Worktable size	500 x 400[mm]
Load [Max.]	150[kg]
Spindle power/ speed [Max.]	6.0kw/32000rpm
Rapid traverse rate	15[m/min]
Feed Rate [Max.]	10[m/min]
Position accuracy	0.008[mm]
Repeatability	0.004[mm]
Machine weight	4000kg
Machine dimension	2010 x 1850 x 2300mm
Power supply	3-PH AC380V ±5% 50Hz

Standard Accessories

- High speed CNC controller
- Precision ball screw and guide rail
- AC servo motor
- High speed motorized spindle
- Automatic tool magazine
- Spindle cooling system
- Lubrication system
- Tool setting sensor

Optional Accessories

- Oil mist collector
- 4th axis rotary table
- Voltage stabilizer
- Probe

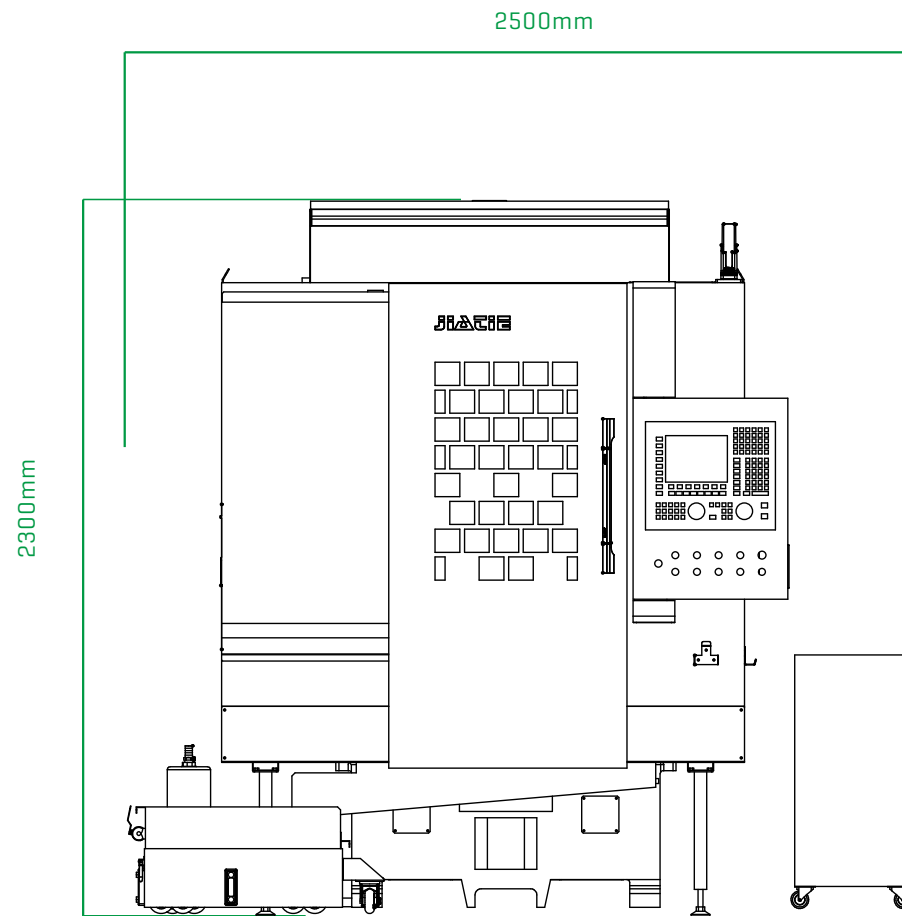

Front

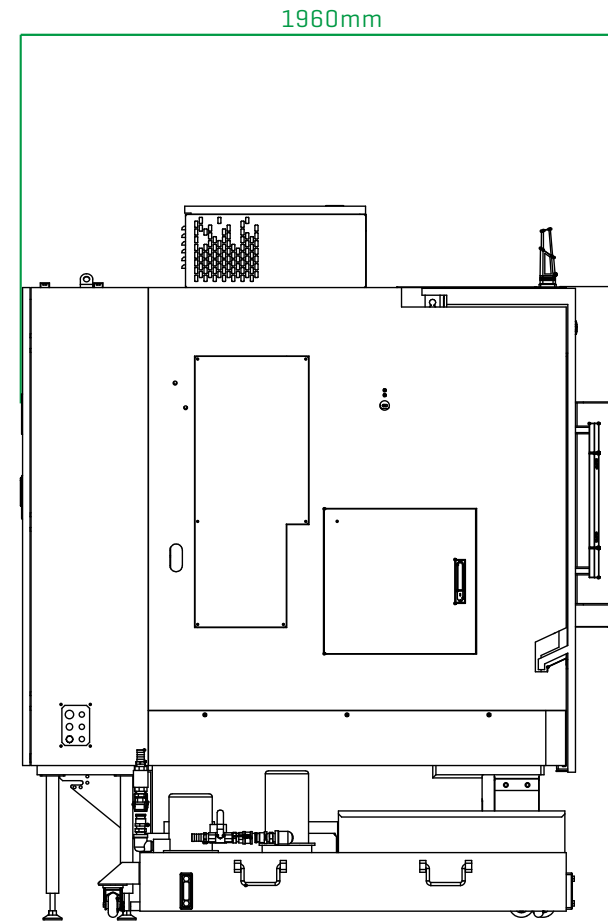

Left